

Royalty Collection

Overage Allowances	Order 5 % more flooring than square footage to account for cuttings and waste
Subfloor Flatness Tolerances	F32 Flatness required - 3/16" in 10' (1/8 in 6' allowed) Slope not more than 1" per 6 ft. (No abrupt height differences. High spots should be sanded or ground down and low areas should be filled)
Vapor Barrier (6 mil polyfilm)	Required on Concrete Subfloors
Should Additional Underlayment (pad) be used?	No -Royalty Collection includes a pre-attached sound-mitigating pad. Do not use any additional sound suppression underlayment or padding, as doing so will void the Limited Warranty
Acclimation Requirements	Residential – 24 Hours Climate Controlled Area Light Commercial – 24 Hours Climate Controlled Area
Transition Requirements	Required when installing Royalty Collection, a room or area that is larger than 60 linear feet in any direction
Installation On Vertical Surfaces (walls)	VOIDS WARRANTY
Installation Over Existing Ceramic Tile Floors	Flatten the Ceramic Tile floor with proper level compound is Required (Follow Subfloor Flatness Tolerances)
Glue Down Installation	VOIDS WARRANTY
Subfloor RH / MVER Limits	85% Relative Humidity / 8 lbs. MVER (Moisture Vapor Emission Rating)
Wood Substrate	Only if it has Controlled HVAC below area laid
Controlled Environments	Must be controlled year-round
Expansion Gap Requirements	5/16" around perimeter walls & heavy fixed objects such as cabinetry, commodes or baths. Never affix
Maximum Run L x W	60' x 60'
Sun Rooms	Do not Install
Load Restrictions	Do not place heavy object on floor more it could restrict movement: i.e.: Hiron Beds, Gun Safes, Fish Tanks, Islands, Bars, Refrigerators, any overloaded furniture.
Wood frame Structure	Black 6 mil poly should be placed on the ground cover. Crawl Space must be well ventilated. Bottom side of subfloor must not exceed 15% moisture content. Conditioned crawl space is required to control moisture content of subfloor if it varies between season and dew point is being reached. This is determined on job by job basis.

KEY INSTALLATION CONSIDERATIONS

Royalty Collection is intended for interior use only and is suitable for above grade, and grade, applications. DO NOT install in any outside areas, sunrooms/solariums, saunas, seasonal porches, camping trailers, boats, RVs, 3-season rooms, lanais, rooms that are prone to flooding, or rooms or homes that are not temperature-controlled. Do not set heavy objects on the floor to restrict the floor. i.e: fish tanks, entertainment centers, toilets, free-standing tubs, kitchen islands

Royalty Collection is a floating floor and should be allowed to expand and contract freely. It must not be glued, nailed, or fastened to the subfloor in any way. The floor should have 1/16" gap between quarter round and floor. Permanent cabinets, vanities, toilets, kitchen islands, and similar items should not be installed first. Then, install Royalty Collection around them, leaving the proper expansion gap. Heavy objects such as fish tanks, refrigerators, bathtubs, entertainment centers can lock the floor.

Royalty Collection is a waterproof floating floor, but it should not be used to seal an existing floor from moisture. Moisture testing should be performed on all jobs. If moisture test fails, the ASTM 8lbs MVER or 85% R.H. use a moisture mitigation process like a 2-part epoxy to mitigate. It cannot inhibit the growth of mold or prevent structural problems associated with, or caused by flooding, on concrete subfloors installation always use 6 mil poly-film after testing excessive moisture, alkalis in the subfloor, or conditions arising from hydrostatic pressure. Regardless of location, always remove standing water, pet urine and other liquids promptly. Job site moisture issues should be addressed and corrected prior to installation.

Long-term exposure to direct sunlight can potentially damage Royalty Collection causing it to discolor, fade, or buckle. Protect the flooring from exposure to direct sunlight via the use of window-treatments or via UV-tinting on windows.

If the flooring is to be installed by a third party, then it is suggested that the homeowner be present during the installation for consultation/direction. The owner and installer should discuss installation and layout to maximize satisfaction. If this is not possible, consultation should occur prior to installation. The owner/installer assumes all responsibility for quality of completed installation they should hire qualified professional to deem the floor is flat and dry before proceeding with the installation. Otherwise, product failure could occur.

TOOLS FOR INSTALLATION:

Utility Knife • Straight Edge • Measuring Tape • ¼" (6mm) Spacers • Pencils • Profiled Tapping Block • Pull Bar • Eye Protection • Soft-Faced Hammer • Broom • Felt or Nylon Pads, and Moisture Meter (wood / concrete)

Optional: Jig Saw • Table Saw • Miter Saw • Circular Saw • Hole Saw

Royalty Collection

PRE-INSTALLATION

Please contact our Customer Service Department at (504) 382-2331 if you have any questions or concerns regarding the installation and/or care & maintenance of Royalty Collection flooring, to ensure that you do not engage in any actions that might void the Royalty Collection Limited Warranty. The installation of Royalty Collection vinyl plank flooring does require 24 - hour acclimation in residential applications if the product is stored properly. If the product is subject to extreme hot or cold temperatures prior to installation, allow the product to acclimate to room temperature. The room of installation must be normal at normal living conditions. The HVAC system must be on and functional before, during and after installation.

Product should be stored horizontally in a dry area away from direct sunlight. Do not leave next to heating or cooling ducts. All work involving water must be completed well in advance of the installation of Royalty Collection. Do not store flooring in uncontrolled environmental conditions. For example, garages and exterior patios are not acceptable areas to store flooring. Flooring stored on a concrete slab should be elevated at least 4" (10.2cm) to allow air circulation under cartons. Ensure that all trades have been completed, including ceramic tile installation, drywall, plasterwork, plumbing, painting, etc.

Locate the run number on the short end of each carton and verify that all the material for your job is from the same run. Minor shade variations within the same run number contribute to the natural look of Royalty Collection. To minimize noticeable shade variation, avoid installing material from different runs across large expanses. A good practice is to work out of multiple boxes to help blend minor color variations. The run -number is the eight-digit number separated by decimal points beginning with the two-digit day, then the two- digit month, and finally the four-digit year.

Run Number 10.05.2017
Day.Month. Year

Randomly pull planks from three different cartons to ensure good color and shade mixture. Carefully inspect each plank for visual defects prior to installation. Do not install damaged planks.

SAFETY AND HEALTH PRECAUTIONS

Power tools can be dangerous. Operate in strict accordance with manufacturer's operating instructions and safety precautions. Unsafe and improper use can cause serious injuries. Avoid inhalation and exposure to airborne particles by wearing personal protective equipment, including NIOSH or OSHA approved dust masks, safety goggles and work gloves.

JOB SITE EVALUATION

Prior to installation, the homeowner or installer must ensure that job site conditions (including subfloor/ substrate, ambient temperature, and relative humidity) will not negatively affect the floor. The manufacturer is not responsible for damages associated with improper installation or poor site conditions. Royalty Collection is a floating floor and should be allowed to expand and contract freely. It must not be glued, nailed, or fastened to the subfloor in any way. Permanent cabinets, vanities, toilets, kitchen islands, and similar items should not be installed on top the floor. Install the floor around them, leaving the proper expansion gap. Heavy objects such as fish tanks, refrigerators, gun safes, bathtubs, entertainment centers can lock the floor.

MOISTURE

TEST ALL CONCRETE subfloors for moisture content and document the results. Visual checks are not reliable. Moisture must still be checked even though Royalty Collection vinyl plank flooring is waterproof to protect surrounding structure. Refer to waterproof definition

Perform moisture tests at locations around exterior doorways, near walls containing plumbing, near foundation walls and in the center of the room.

Moisture requirements vary by subfloor; please see the following details that correspond to the appropriate subfloor.

CRAWL SPACES

Concrete slab or ground must be dry. Crawl spaces relative humidity must be controlled year-round below 80% R.H. WE DO NOT WARRANT INSTALLATION OVER CRAWL SPACES WITHOUT RELATIVE HUMIDITY CONTROL YEAR-ROUND.

APPROVED SUBFLOORS

Concrete, APA RATED: Plywood, OSB. NEVER LAY FLOOR OVER AN EXISTING GLUE-DOWN ENGINEERED FLOOR OR SOLID NAILDOWN EXISTING FLOORS

All subfloor requirements noted below must be met prior to the installation of Royalty Collection vinyl plank flooring.

GENERAL REQUIREMENTS (ALL SUBFLOORS)

- Must be level to within ¼" in a 10ft. (6mm in a 3m) span; no bumps or low spots. Subfloors should not slope more than 1" per 6ft. (25mm per 1.8m).
- Must be clean: no construction debris, soil, mud, or any other objects on or adhering to the floor; if necessary, scrape and sweep away before the installation; no protrusions of nails, debris, or metals should remain.
- Must be free from moisture-related conditions that can damage the installed flooring.
- Be structurally sound without deflection.

CONCRETE SUBFLOORS

- High spots can be removed by grinding; depressions can be filled with cementitious patching compound formulated for use in floor installation.
- Cure for at least 90 days (applies to newly laid concrete slabs).
- Can be either sealed or unsealed.
- Between 7 and 9 alkalinity when performing pH test (ASTM F710).
- Moisture content should meet one of the following criteria:
 - Less than 3 pounds per 1000 sq. ft. per 24 hours MVER (Moisture Vapor Emission Rating) when using Calcium Chloride test (ASTM F1869).
 - 75% max. when performing Relative Humidity Testing (ASTM F2170).

Royalty Collection

- If all moisture testing comes back within normal range 6 mil poly should be applied over the slab lapping and taping joints with 3M duct tape. If moisture test fail moisture migration is required. Follow moisture mitigation manufacturer's instructions if needed.

WOOD (PLYWOOD, OSB) SUBFLOORS WITH CONTROL HVAC AREA BELOW

- Wood subfloors must be A.P.A approved with a minimum grade of "BB" or "CC". For reference, A.P.A. is the acronym for an organization originally known as the "American Plywood Association", and that is now known as "The Engineered Wood Association".
- Perform moisture tests using a reliable moisture meter in multiple locations. Moisture readings should never exceed 14% for plywood, OSB. If moisture readings exceed 14%, it should be corrected at the job site before installing Royalty Collection vinyl plank flooring.
- TILE, TERRAZZO, ASBESTOS TILE, RESILIENT TILE, NON-CUSHION SHEET VINYL, AND METAL SUBFLOORS
- Existing floors must be firmly attached to the structural floor.
- Fill in grout lines around ceramic tiles, terrazzo, quarry tiles, and similar floors with a cementitious leveling and patching compound. Follow manufacturers' instruction and flatten subfloor
- Install over one layer of vinyl only.
- On raised wood frame homes humidity in the crawlspace must be set at 75% RH.

NON-APPROVED SUBFLOORS

- Carpeting/Carpet Pad
- Floating Floors
- Parquet Over Concrete
- Eng. Hardwood Over Concrete
- Hardwood Over Concrete
- Cushioned Vinyl Flooring
- Laminate
- Cork
- Sleeper Substrates
- Rubber

- Remove the floors noted above and remove old adhesive before installing Royalty Collection vinyl plank flooring.
- CAUTION: If you contemplate the removal of a resilient floor covering structure that contains (or is presumed to contain) asbestos, you must review and comply with all applicable local government regulations. Do not sand, dry sweep, dry scrape, drill, saw, bead blast, or mechanically chip or pulverize existing resilient flooring, backing, lining felt, asphalt "cut-back" adhesive, or other adhesive. These products may contain asbestos fibers and/or crystalline silica. Avoid creating dust. Inhalation of such dust is a cancer and respiratory tract hazard. Smoking by individuals exposed to asbestos fibers greatly increases the risk of bodily harm. Unless positively certain that the product is a non-asbestos containing material, you must presume it contains asbestos. See "Recommended Work Practices for Removal of Resilient Floor Coverings" (rfci.com) for detailed information and instructions on removing all resilient covering structures.

Staggered Lay

Royalty Collection vinyl plank flooring should be staggered with a minimum 12" joints to ensure end-joint structural integrity.

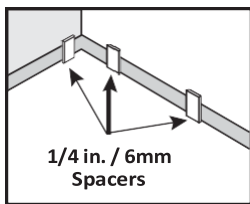
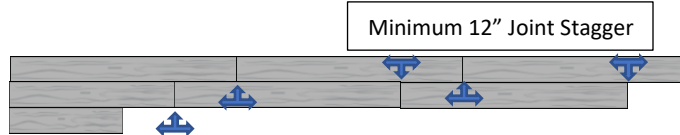

INSTALLATION

INSTALLING FIRST ROW

1 Set spacers to allow a minimum gap of 1/4" (6mm) around the perimeter of the subfloor for movement of product expansion. Lay 6 mil polyfilm over concrete substrate. Do not remove the spacers until the installation is complete. The expansion gaps should be covered by molding.

2 Measure the length of the room in inches. Divide it by the length of the planks (xx"). If the resulting number is less than 12", you will need to cut your first plank accordingly to avoid having planks that are less than 12" on the opposite end of the room.

Note: To cut a plank, simply measure and mark the plank. Then, use a straight edge and utility knife to score and snap. You will also need to back-cut the under pad on the bottom of the plank. If you have difficulty using this method, you can use a jig saw, circular saw or miter saw.

3 Installation should start in a left-hand corner and proceed from the wall with the tongue facing the wall. Position the first plank 7.8" (198 mm) from the starting wall but not up against the spacers. The entire row will be moved against the spacers in a later step.

4 Connect the long sides of the first two planks, making sure the end joints line up evenly. Then, interlock the next plank at the end joints of the first two planks by inserting the tongue into the groove of the adjoining planks. Square the joints by tapping the long edge with the profiled tapping block and soft-faced hammer. Next, lightly tap down on top of

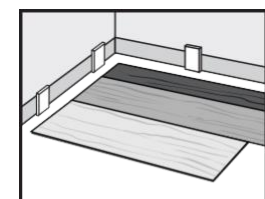
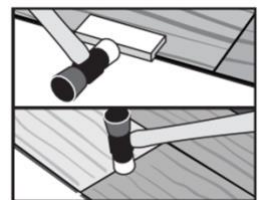
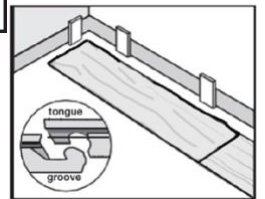
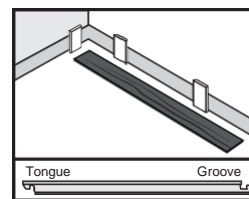

Royalty Collection

the plank at the short joint with the soft-faced hammer. Continue this method to finish the first row.

Cut the last piece of the row to fit and allow for the 1/4" (6mm) expansion gap (if you have not already done so). Install as above. already done so).

INSTALLING SECOND & REMAINING ROWS

- 5** Cut the first plank of the second row to two-thirds its length or make sure there will be at least a 12" (30.5cm) stagger between end joints. Angle the long tongue edge of the plank into the long groove edge of the first plank. Drop and lock the end joints together.

Make sure there are no gaps and, if necessary, tap along the long groove edge using the soft-faced hammer and profiled tapping block to ensure a tight fit.

Do not tap the short end into place if the long joint is not properly engaged, as doing so can cause damage to the tongue and groove.

Note: When starting a new row, you can use the cut piece from the previous row, as long as it is more than 12" and the stagger between seams still is greater than 12"

- 6** Attach the second plank by connecting the long side to the first row and sliding it up to the short end of the first plank. Check that the long joints of the planks are properly engaged and then press the short joint into place with your fingers.

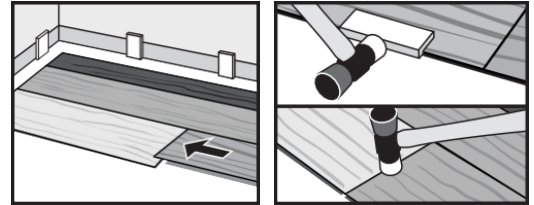

- 7** Continue to square the joints by tapping the long edge with the profiled tapping block and soft-faced hammer. Then, lightly tap down on top of the plank at the short joint with the soft-faced hammer. Continue installing the remainder of the row in this fashion.

- 8** After installing the last piece of the second row, slide the entire assembly against the spacers on the starting wall, maintaining the required 1/4" (6mm) expansion gap.

- 9** Install remaining rows, one row after the other, and maintain the required 12" (30.5cm) stagger throughout the install. Tap and square each plank as in step 7.

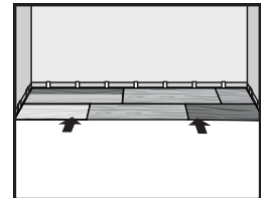

INSTALLING THE LAST ROW

- 10** Most often the entire length of the last row will need to be cut so that it is narrow enough to fit the remaining space. Cut the first plank of the last row to length (if necessary, to follow stagger pattern). Place directly on top of the previously installed row. Then, take another plank and place it against the wall on top of the plank to be cut for width. Mark the plank (length-wise), cut to size. Remember to allow for the 1/4" (6mm) expansion gap against fixed objects.

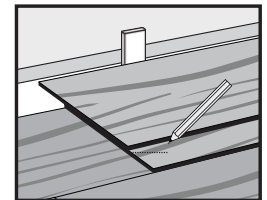

- 11** Install the plank with the cut side always facing the wall. Use a pull bar to lock the long edges together. Do not use the pull bar on the short edges.

Continue to cut and install remainder of the planks in the last row.

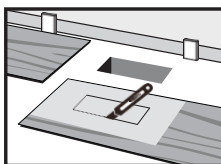
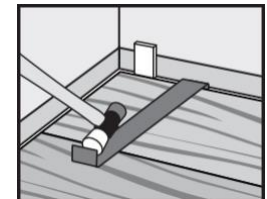

FITTING AROUND IRREGULARLY SHAPED OBJECTS

Make a template to fit around pipes or irregularly shaped objects. Place the pattern upon the plank and trace. Cut along the trace lines using a utility knife or jig saw, and lay plank. Alternatively, a hole saw can be used when cutting planks that are to fit around pipes.

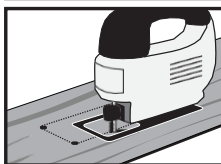

Note: Be sure to leave a minimum of 1/4" (6mm) expansion space around all fixed objects, cabinetry, and metal door jambs.

FINISHING THE JOB

Royalty Collection

Remove spacers. Cover expansion spaces with quarter round or other trim, being sure not to trap or pin down the floor. Nails should go into wall, not the floor. Quarter round should have 1/16" gap between floor and quarter round to allow expansion and contraction. Fill any expansion spaces around potentially wet areas (such as refrigerators, tubs, toilets etc.) with premium, waterproof 100% silicone caulk. Remember, the use of coordinating T-Molds is required when installing Royalty Collection in a room or area that is larger than 60 linear feet (18.2 meters) in any direction, so that the floor is separated into sections that are no larger than 60ft. x 60 ft. (18.2 meters x 18.2 meters) per section. When putting furniture back make sure felt protectors are install on all furniture. Most furniture has a hard plastic that can scratch vinyl. Vinyl floors use the same protectors that are used on a wood floor. Save and protect any leftover planks. Do not store leftover planks in attic. Planks should be stored in a climate-controlled area. In closet or under a bed Do not discard, as they are color-matched (by dye-lot) to your floor. They can be used for replacement in the event you need to replace a plank in the future. Store in a climatized area in top of a closet or under a bed. Do not store in an attic or garage where temperature is regulated this could damage the extra stock.

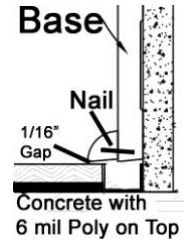

CARE & MAINTENANCE

DAILY MAINTENANCE

- **DO NOT** use a steam cleaner.
- **DO NOT** vacuum with a beater bar or power rotary brush head.
- **DO NOT** use any cleaning agents containing wax, oil or polish. Leftover residue will form a dull film.
- **DO NOT** use steel wool or scouring pad, as they will scratch the floor.
- **DO NOT** use any dust cleaners, as they may cause your floor to become slick or damage the finish.
- **DO NOT** use vinegar.
- **DO NOT** use any All-Purpose or Multi-Purpose cleaners.
- **DO NOT** use wet sweeper pads. Dry sweeper pads can be used.

- Regularly sweep, dust, damp mop, or vacuum (without beater bar) your floor to remove any particles that could cause abrasions or scratches to appear on your floor.
- Use a damp mop to remove spots and soil. Use any pH neutral floor cleaner like Bona Kemi cleaning system for vinyl floors.
- For lightly soiled areas, clean with distilled water Bona Kemi Professional Cleaner.
- When the cleaning cloth/mop becomes soiled, rinse or replace it with a clean one. Following up with a clean, dry cloth will remove residual streak-marks and spots.
- Avoid spills of acidic products (juice, soft drinks, wine, etc.) on the floor. Clean spots immediately.
- Promptly remove any standing water, pet urine or other liquids.
- Paints, dyes, or harsh chemicals can leave blemishes.

FLOOR REPAIR

- Deep scratches may require the replacement of planks. A plank replacement video is available on YouTube.

PREVENTATIVE MAINTENANCE

- Protect your floor when using a dolly to move furniture or appliances. Protective sheets and/or plywood should be laid down to protect from cracking end joints. Never slide or roll heavy furniture or appliances across the floor. Heavy objects can crack the locking system if not protected.
- Use flat floor protectors (nylon or felt used for wood floors) on all furniture legs. Periodically clean protectors to remove grit that may become embedded and cause scratching.
- Minimize abrasive material and dirt by placing mats on both sides of exterior doors and by using area rugs in high-traffic areas.
- Use protective mats beneath rolling chairs and keep furniture casters clean. Not for use with Hilon beds or hospital beds or any heavy rolling object causing structural loads that could compromise joint lock systems.
- Use NON-RUBBER backed mats that are labeled "colorfast" by the manufacturer. Non-staining, vinyl- backed mats or woven rugs should be used at all entrances to avoid discoloration from asphalt driveways and to prevent dirt and grit from being tracked onto your floor. Rubber and latex-backed mats use a chemical (antioxidant) to keep the backing from becoming brittle; it is this chemical that can permanently stain your floor.
- We recommend the use of a hard surface (non-studded), non-rubber chair mat to protect your floor from office chairs with casters. Light, rolling furniture should be outfitted with broad-surface, non-staining casters that have been engineered for hard surface floors. Such casters should be a minimum of 1" (2.5cm) wide and at least 2" (5.1cm) in diameter.
- Keep pets' nails trimmed.
- Remove shoes with cleats, spikes, or exceptionally pointy heels before walking on the floor.

Royalty Collection

WARRANTY TO ORIGINAL OWNER

PRODUCTS & COVERAGE

Royalty Collection flooring will be free from manufacturing defects and, under normal use and maintenance, will not wear, fade or stain resulting in loss of original pattern and color, and the structural integrity of the flooring itself will not be materially damaged by water exposure, for a specified length of time from the date of purchase as set forth in the Warranty Coverage chart on the right. This Limited Warranty only applies provided the flooring covered by this warranty is installed and maintained according to the Royalty Collection Installation Instructions.

PRE-INSTALLATION

Royalty Collection warrants that its flooring is free of visual defects. You and/or your installer should carefully inspect each piece before installation. Any pieces that appear to have defects should not be installed. Royalty Collection will not be responsible for any claim for flooring installed with visual defects.

INSTALLATION

This Limited Warranty covers materials only, provided that such flooring is installed according to the Royalty Collection Installation Instructions. These Instructions are revised periodically, and floors must be installed according to the current Instructions at the time of installation. Please check LockandGoFlooring.com for the current Royalty Collection Installation Instructions.

REPLACEMENT / REPAIRS

Royalty Collection reserves the right to repair any flooring and/or to use its own source to obtain an installer for replacement flooring. If Royalty Collection repairs or replaces any flooring as a result of a warranty claim, you will be required to clear, at your own expense, any items placed over the affected areas subsequent to the original installation. In the event that Royalty Collection repairs or replaces any flooring covered under this Limited Warranty, this Limited Warranty shall remain in effect with respect to such flooring for a period limited to the remaining eligible duration of the original Limited Warranty prorated.

TERMS FOR WARRANTY TO THE ORIGINAL OWNER

If a defect covered by this Limited Warranty is found within the warranty period and reported to Royalty Collection will supply new flooring material of similar color, pattern and quality to replace the defective area. THEY AMOUNT IS PRORATED OVER THE LIFE OF THE WARRANTY. THIS WARRRNTY IS FOR THE ORIGINAL OWNER AND IS NONTRANSFERRABLE.

In case of questions regarding the terms of this Limited Warranty, contact Royalty Collection Customer Service at 504-309-6922. Royalty Collection reserves the right to inspect any flooring, request samples, secure photographs or any other information that may be required to ascertain the nature of any claim under this Limited Warranty.

EXCLUSIONS

The following are not covered by this Limited Warranty:

- Dissatisfaction or damage due to improper installation or maintenance, including use of improper cleaning solutions or finishes, unevenness, or irregularities. Refer to the Royalty Collection Installation Instructions for more details.
- Damage caused by fire, burns, abuse, flooding, spills, scratches, abrasive scouring pads, scuffing, staining, construction, or installation.
- Damage caused by vacuum cleaner beater bar, indentations or damage caused by spiked heeled shoes, improper rolling loads, caster wheels, chairs or other furniture without proper floor protectors and cuts from sharp objects.
- Changes in color or sheen from exposure to sunlight or due to use of rubber-backed mats.
- Exterior applications.
- Loss of gloss.
- Minor shading, color or texture differences between samples or printed color photographs or illustrations and delivered product.
- Flooring sold as irregulars or trial grade materials or "as is".

WARRANTY COVERAGE

WARRANTY COVERAGE	Manufacturing Defect, Wear, Fade, Stain, and Water Damage*	
WEAR LAYER	RESIDENTIAL	COMMERCIAL
12mil (0.3mm)	Limited Lifetime	10 Years Light**
<p>*DEFINITIONS / TO BE COVERED: Wear: must be through the wear layer to the degree that the printed pattern is affected or altered. Fade: must be to the degree that the floor is permanently discolored. Stain: must be from normal household cleaning agents, chemicals, or routine care & maintenance. Water Damage: covers structural-integrity damage to the flooring itself after water exposure in standard conditions (does not cover flooding or slabs emitting high moisture). **Light Commercial: refers to environments such as private offices, common areas in multiunit dwellings, reception areas and public buildings or businesses which are not subject to frequent and harsh traffic.</p>		

This flooring should not be used to seal an existing floor from moisture, it is a floating floor which is waterproof, but this flooring cannot prevent problems associated with or caused by flooding, excessive moisture or alkalis in the subfloor or conditions arising from hydrostatic pressure.

- Only installation techniques described in the Royalty Collection Installation Instructions are warranted. This warranty does not warrant Royalty Collection installations involving custom cutting, such as 45-degree mitered corners and serpentine edges. Furthermore, this warranty does not warrant Royalty Collection installations in which the flooring is adhered (glued or nailed) to the subfloor, as Royalty Collection is a floating floor.
- Loss due to loss of time, inconvenience, incidental expenses (such as telephone calls, labor and/or materials) incurred in the removal or re-installation of the affected material, and any other incidental or consequential damages.

THIS LIMITED WARRANTY IS IN LIEU OF ANY OTHER WARRANTIES, EXPRESSED OR IMPLIED. PLEASE KEEP YOUR RECEIPT FROM YOUR PURCHASE. ROYALTY COLLECTION REQUIRES A VALID PROOF OF PURCHASE IN THE FORM OF SALES RECEIPT, INVOICE, OR STATEMENT, WHICH SHOWS THE DATE, PRODUCT AND LOCATION PURCHASED. ORIGINAL RECEIPTS ARE PRONE TO FADING OVER TIME. WE SUGGEST THAT YOU MAKE A PHOTOCOPY OR SCAN YOUR RECEIPT FOR FUTURE WARRANTY PURPOSES.

Royalty Collection